

Craftsman Style Playhouse

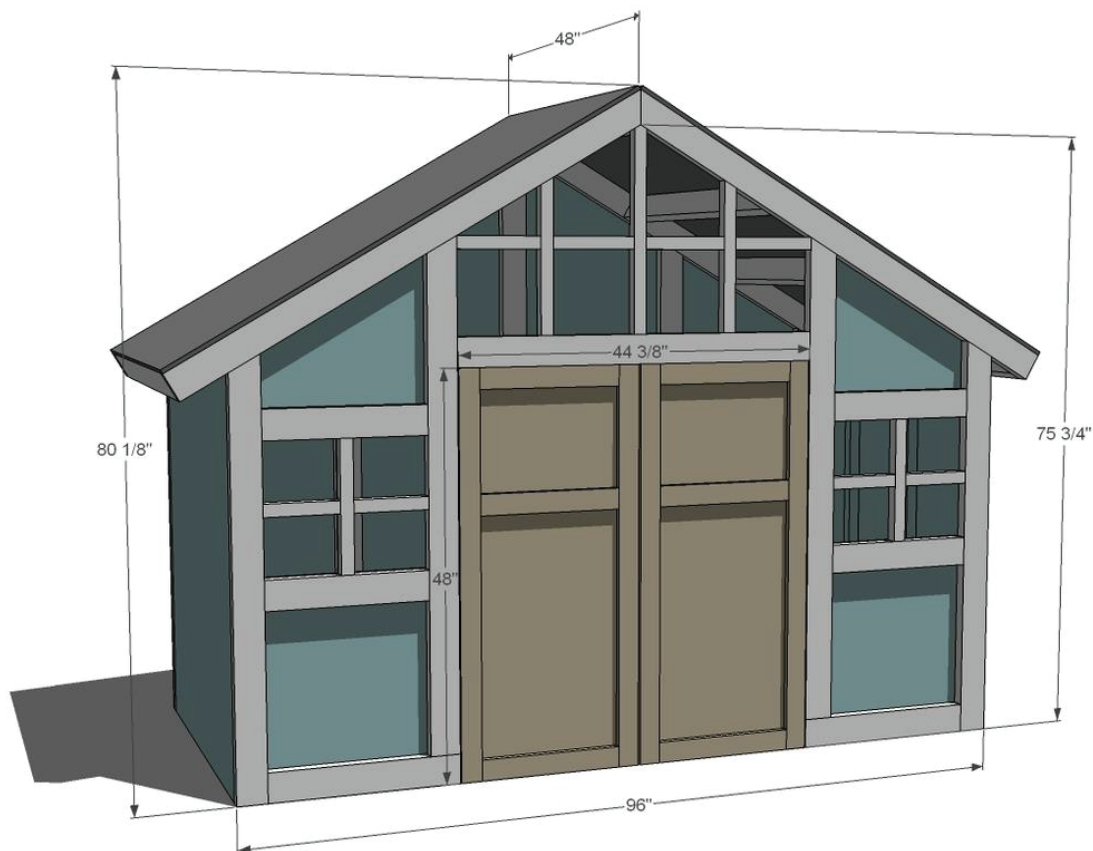

SHOPPING LIST

- 5 - 4x8 sheets CULPEPER 3/8" exterior plywood
- 8 - CULPEPER GROUND CONTACT 2x2 @ 8 feet long
- 20 - CULPEPER GROUND CONTACT 2x4 @ 8 feet long
- CULPEPER 1x3s for doors if desired
- 2-1/2" pocket hole screws (blue coated exterior ones)
- Galvanized nails or screws for attaching plywood
- Roofing of choice

GENERAL INSTRUCTIONS

Take all necessary precautions to build safely and smartly. Work on a clean level surface, free of imperfections or debris. Always use straight boards. Check for square after each step. Always predrill holes before attaching with screws. Use glue with finish nails for a stronger hold. Wipe excess glue off bare wood for stained projects, as dried glue will not take stain.

STEP 2

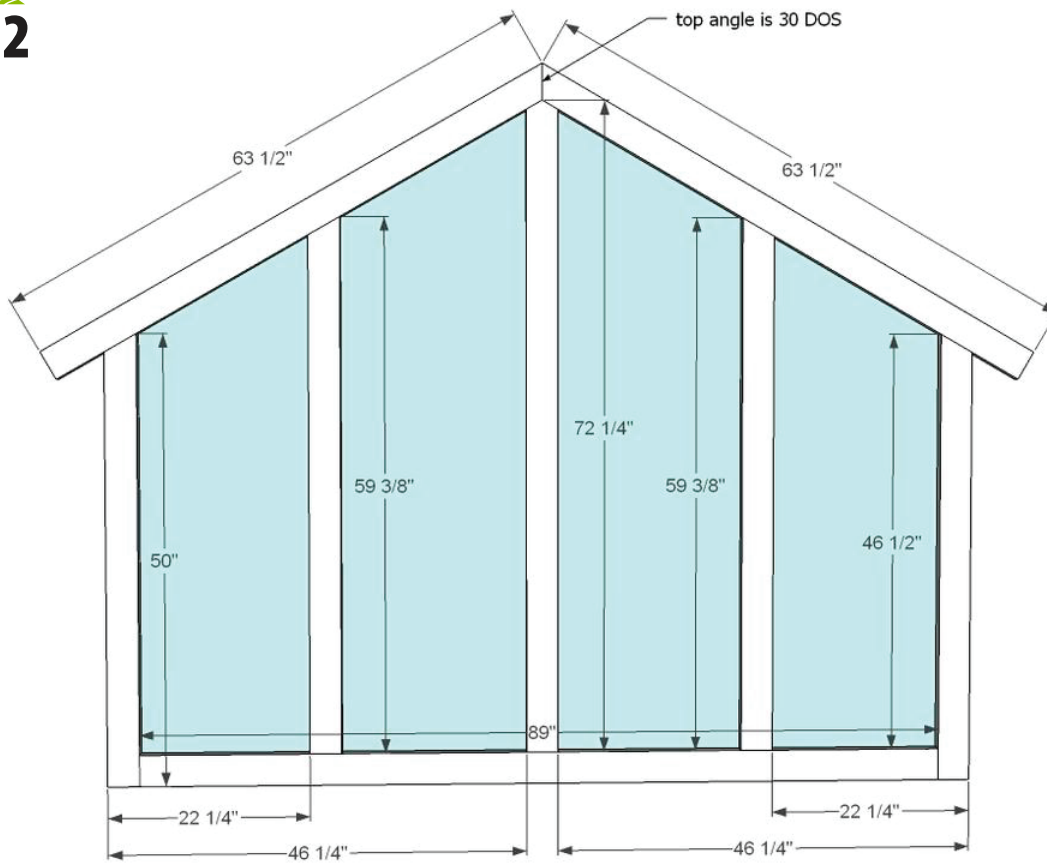

ROOF OVERHANG ON UNDERSIDE OF RAFTERS IS 6"

BACK WALL

- 2 – 2x4 @ $63\frac{1}{2}$ " – one end cut at 30 degrees off square
- 2 – 2x4 @ 50" – one end cut at 30 degrees off square
- 2 – 2x4 @ $59\frac{3}{8}$ " – one end cut at 30 degrees off square
- 1 – 2x4 @ $62\frac{1}{4}$ " – top dogeared to point at 30 degrees off square
- 1 – 2x4 @ 89" 2 - $\frac{3}{8}$ " exterior plywood 48" cut to fit - save scraps for the front wall.

Build the back wall on the ground, using the Kreg Jig. The blue is $\frac{3}{8}$ " exterior plywood nailed on to back. Again, 2x4 boards are joined together flat, so wall is 1- $\frac{1}{2}$ " thick before plywood is attached.

STEP 3

SIDE WALLS – BUILD 2

- 12 – 2x2 @ 45"
- 2 – 1/2" plywood @ 45" x 48"

Build both of the side walls -using the Kreg Jig.

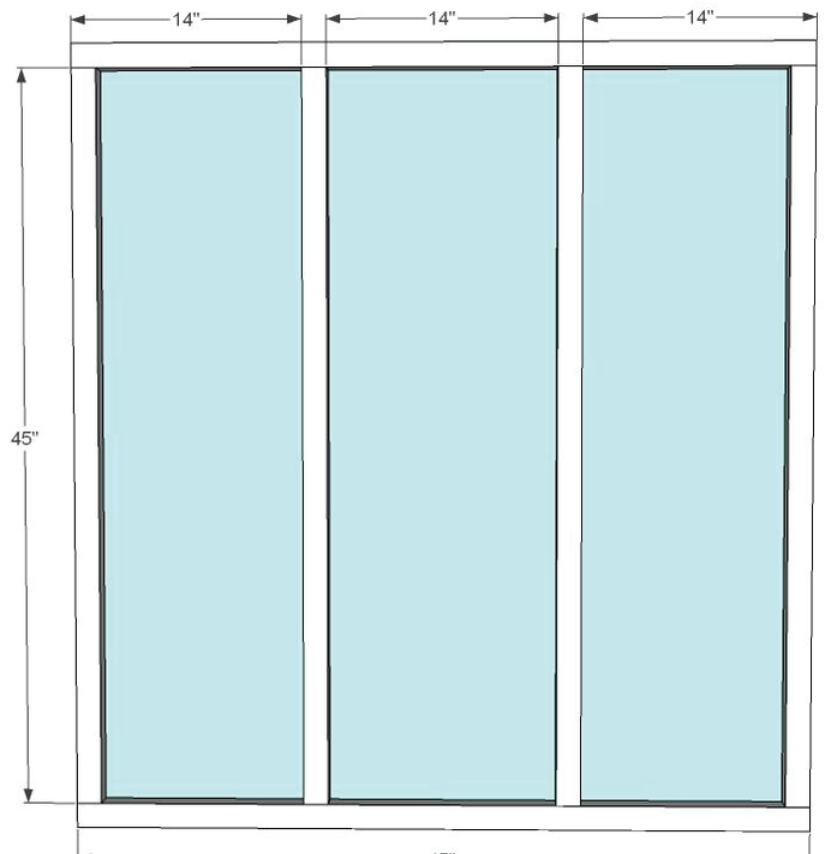

STEP 4

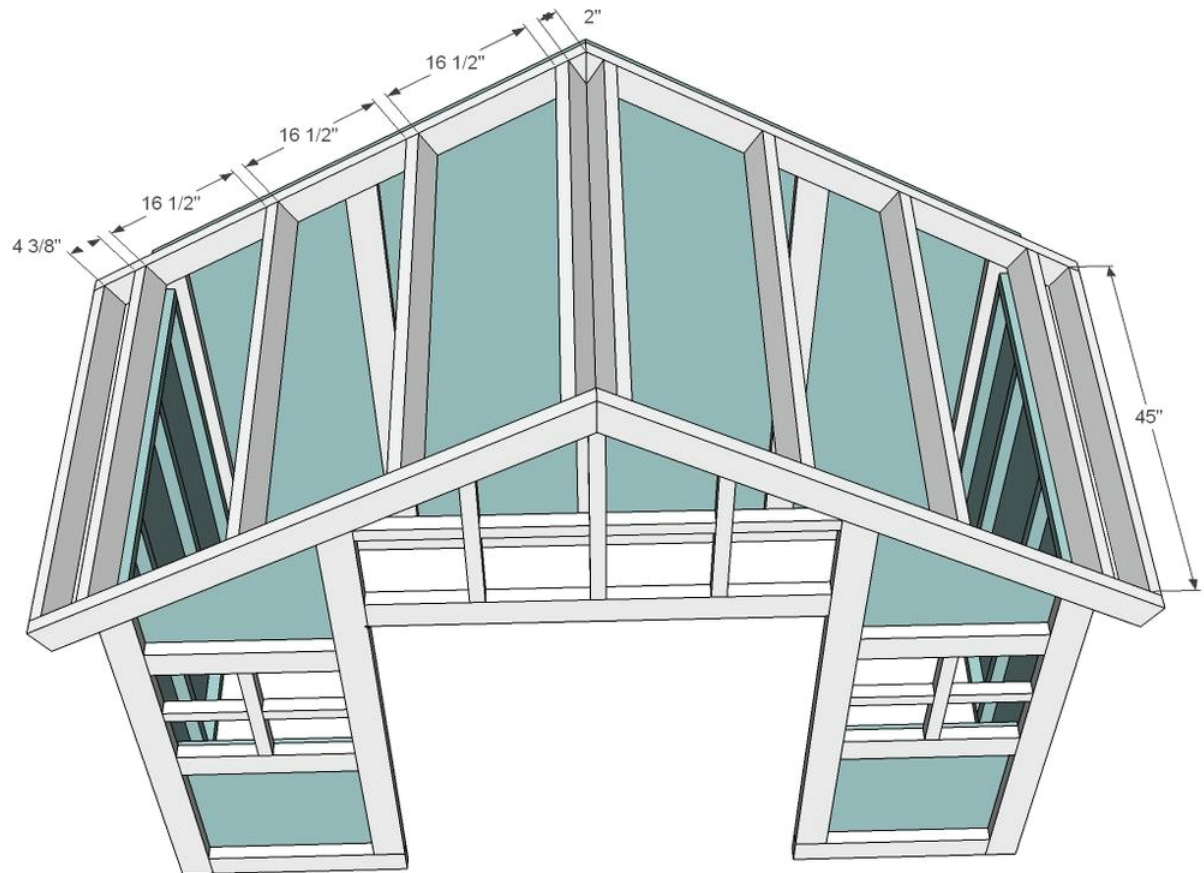

Once all the walls were built, attached the front and back walls to the side walls to create the walls of the playhouse. Then add rafters to make the roof.

RAFTERS

- 10 – 2x4 @ 45"

STEP 5

Attach roof plywood to top.



STEP 6

(Continued on next page)

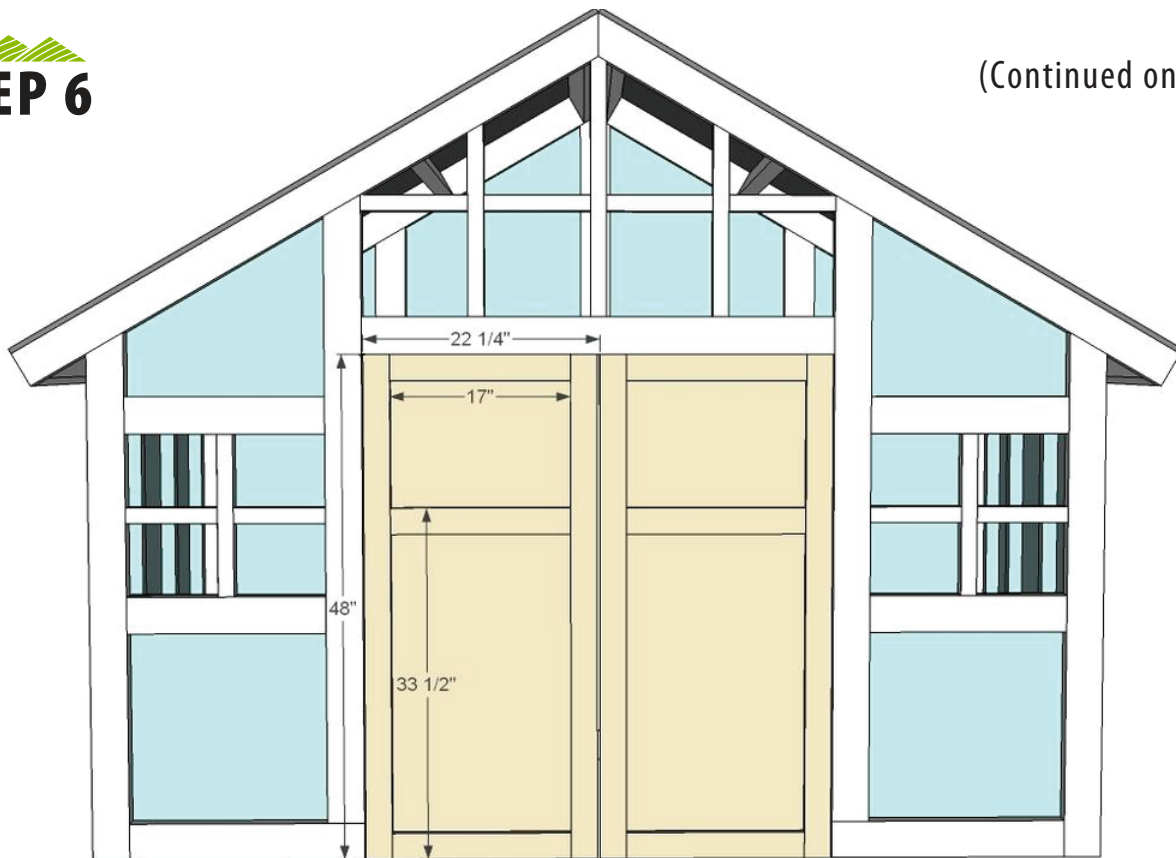

DOORS

BUILD TO YOUR OPENINGS

We recommend leaving generous gaps around the doors to prevent finger pinching.

- 4 – 1x3 @ 48"
- 6 – 1x3 @ 17"
- 2- ½" plywood @ 22 ¼" x 48"

Build doors out of 1x3s and add 3/8" plywood to the back.

Trim 2" off the bottoms of the doors so no toes get scraped underneath the door.

FINISHING/PREPARATION INSTRUCTIONS

Fill all holes with wood filler and let dry. Apply additional coats of wood filler as needed.

When wood filler is completely dry, sand the project in the direction of the wood grain with 120 grit sandpaper. Vacuum sanded project to remove sanding residue. Remove all sanding residue on work surfaces as well.

Wipe project clean with damp cloth.

It is always recommended to apply a test coat on a hidden area or scrap piece to ensure color evenness and adhesion.

Use primer or wood conditioner as needed.